

**ASSEMBLY & INSTALLATION NOTES**

**JUBU brake cooling rear axle - Road, Track & Race**

for all Exige S3

Please follow the instructions in this manual for a proper assembly & installation of the JUBU brake cooling front axle - Road & Track.

Please find in this document:

1. PART LIST
2. ASSEMBLY & INSTALLATION NOTES

**1. PART LIST for JU00078PRD**

#	ITEM	ART-NO.	UNITS
1	Brake cooling duct Road & Track Exige rear axle right	JU00115ART	1
2	Brake cooling duct Road & Track Exige rear axle left	JU00116ART	1
3	Cable ties (HD) 7.5x360	-	6



Fig 1: Scope of delivery

## 2. ASSEMBLY & INSTALLATION NOTES

1. Please mount the brake cooling ducts (1 & 2) as shown on Fig. 2 and Fig. 3. Use the supplied cable ties.

**⚠ NOTE: Don't over tighten the cable ties.**

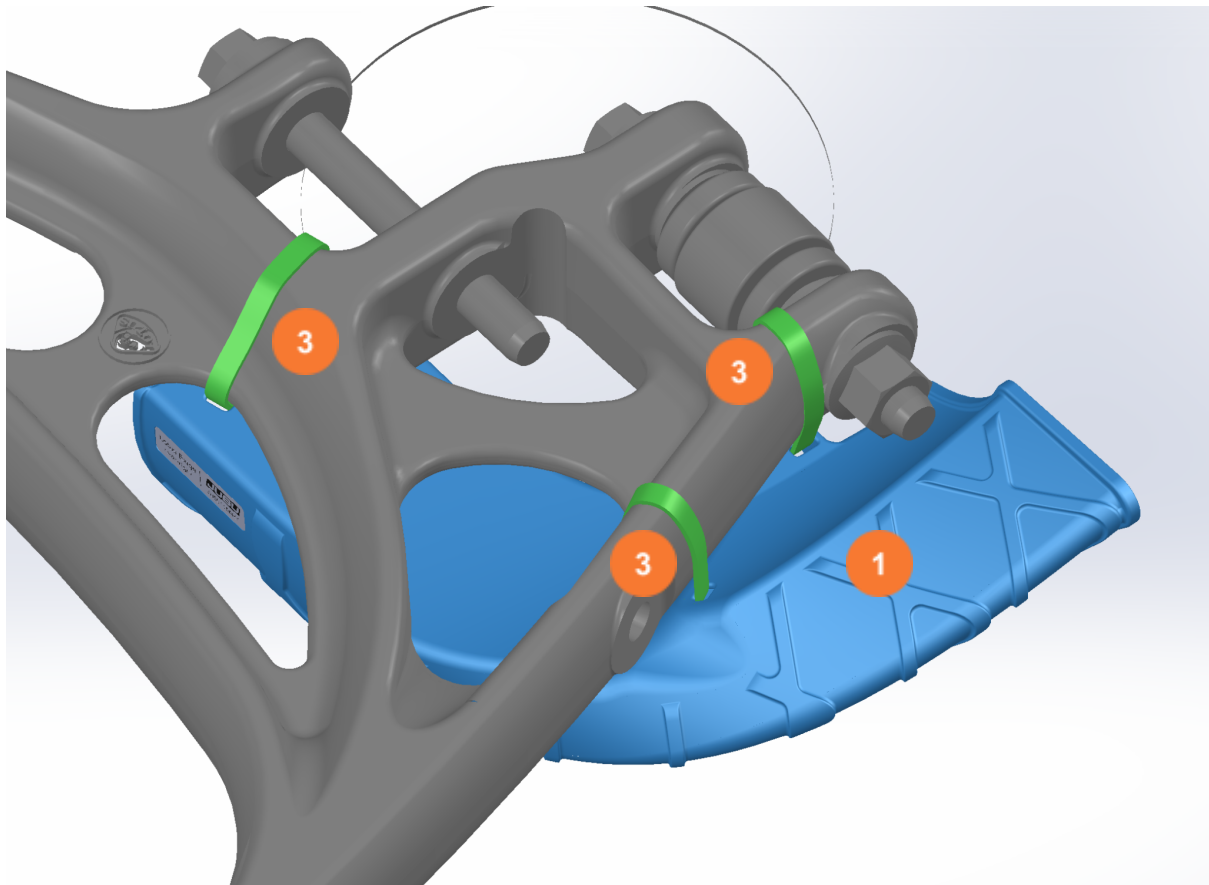

Fig. 2: Correct assembly and placement of the cable ties (rear right) (I)

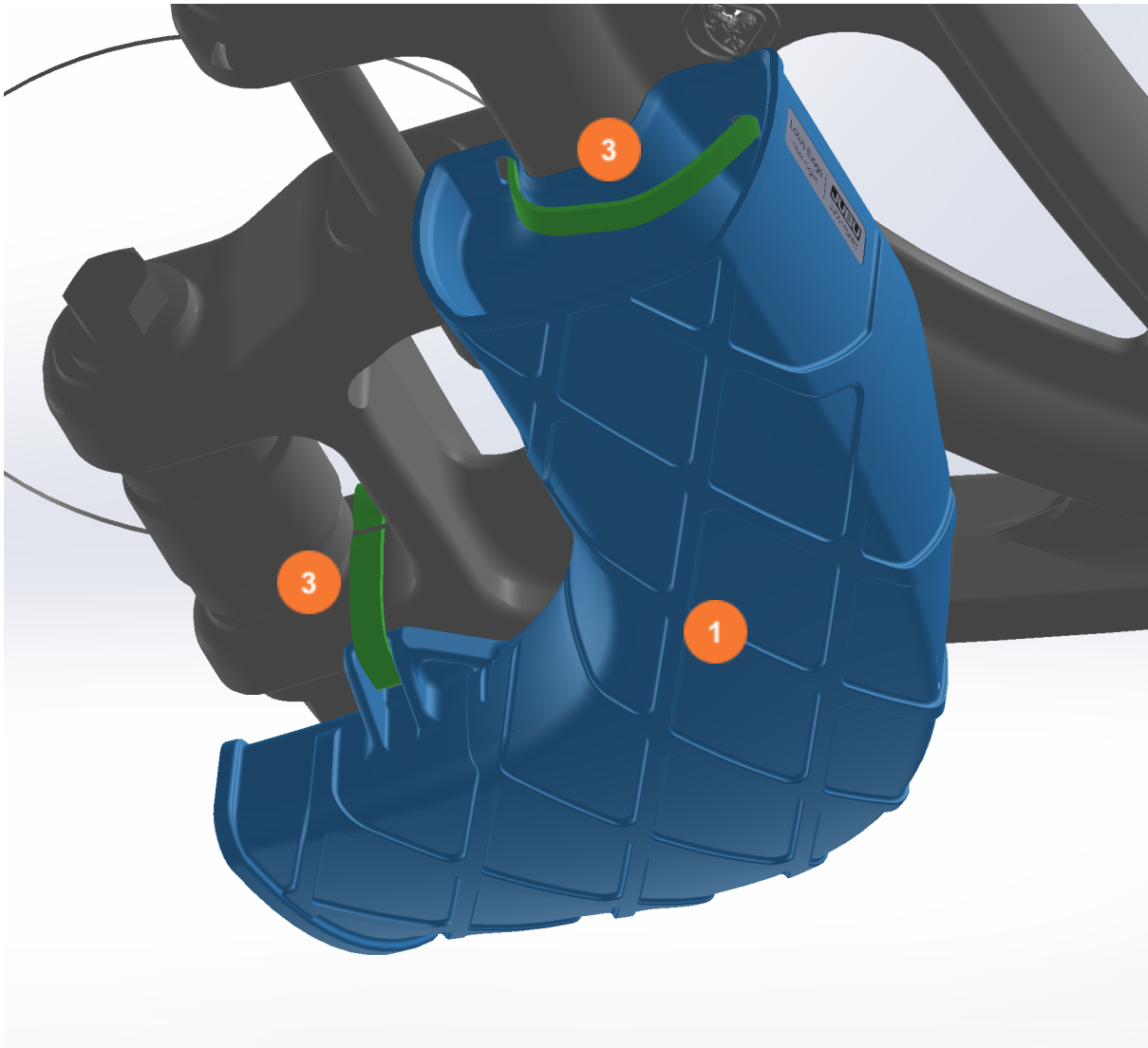

Fig. 3: Correct assembly and placement of the cable ties (rear right) (II)

\*\*\*\*\*

If you have any questions or need additional information, please contact us by email:

[info@jubu-performance.com](mailto:info@jubu-performance.com)

**JUBU Performance GmbH**

Saxenegg 3a, 4323 Münzbach, AUSTRIA