

ASSEMBLY & INSTALLATION NOTES

JUBU brake cooling front axle - Road & Track

for Elise S2 & S3

Please follow the instructions in this manual for a proper assembly & installation of the JUBU brake cooling front axle - Road & Track.

Please find in this document:

- 1. PART LIST**
- 2. ASSEMBLY & INSTALLATION NOTES**

1. PART LIST for product JU00218PRD

#	ITEM	ART-NO.	UNITS
1	Brake cooling scoop Road & Track Elise front axle left	JU00343ART	1
2	Brake cooling scoop Road & Track Elise front axle right	JU00344ART	1
3	Cable ties (HD) 7.5x360	-	4
4	Bodywork adhesive	-	1

[Bild von Scope of delivery]

Fig 1: Scope of delivery

2. ASSEMBLY & INSTALLATION NOTES

1. Please mount the brake cooling ducts (1 & 2) as shown on Fig. 2 and Fig. 3. Use the supplied cable ties.

⚠ NOTE: For additional securing, bodywork adhesive (4) can be applied between the brake cooling ducts and the tube of the lower wishbones.

⚠ NOTE: Don't over tighten the cable ties.

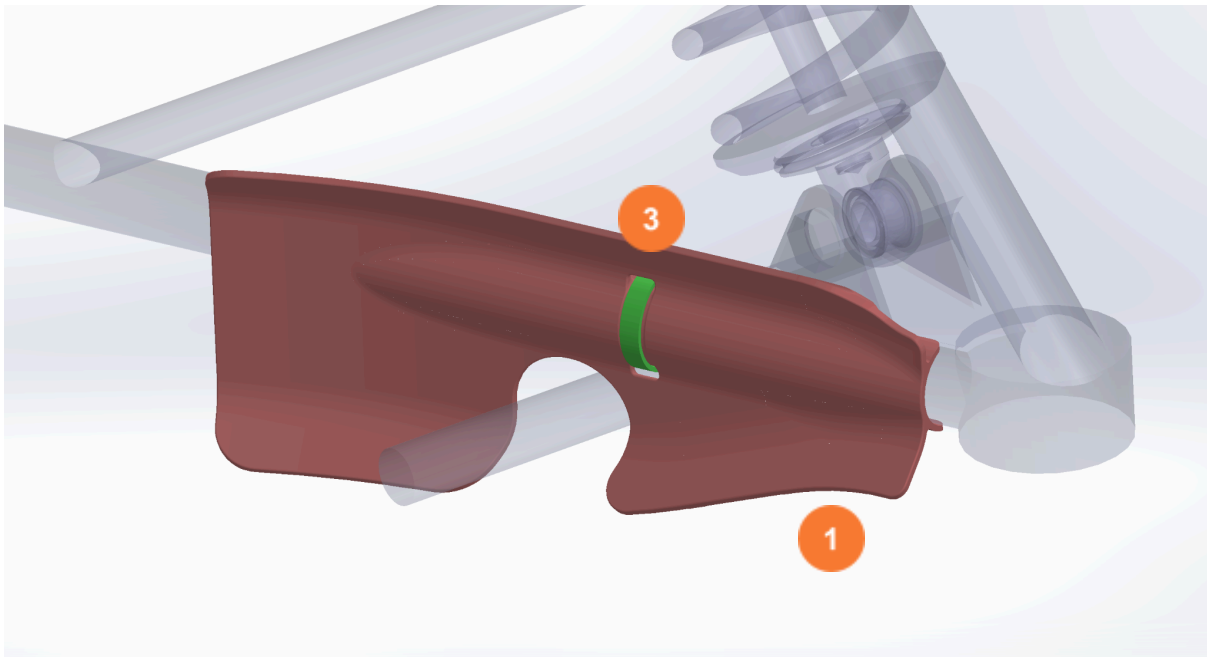

Fig. 2: Correct assembly and placement of the cable ties (front left) (I)

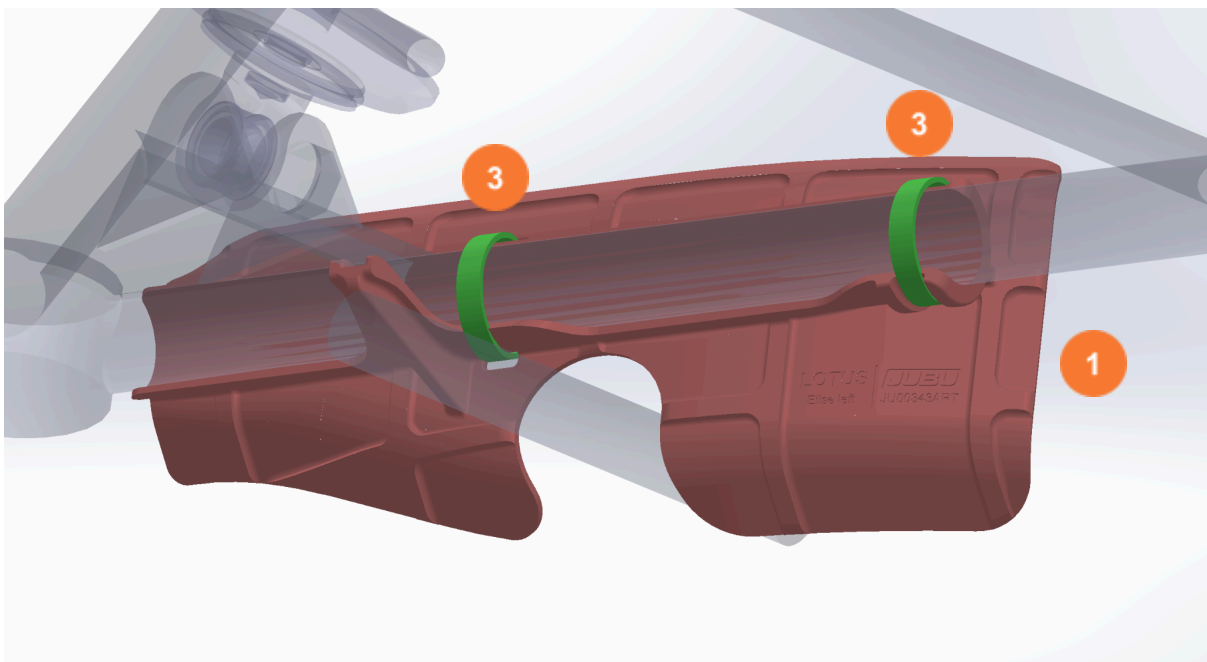

Fig. 3: Correct assembly and placement of the cable ties (front left) (II)

If you have any questions or need additional information, please contact us by email:

info@jubu-performance.com

JUBU Performance GmbH

Saxenegg 3a, 4323 Münzbach, AUSTRIA